



PK SW215 | Compact Stage Monitor

FEATURES & BENEFITS

- High efficiency self-powered modules
- Extremely low profile
- Small Footprint
- Exceptional fidelity and output
- Ultra low distortion
- Selectable DSP configurations
- 60 degree conical pattern



The PK SW215 low profile, self-powered, two-way loudspeaker offers precise high output capability in a compact, efficient stage wedge.

Coaxial point source technology provides excellent frequency response linearity with low distortion in an extremely small enclosure.

An ideal monitor for both live sound applications and DJ, the SW215 is incredibly clear and intelligible providing an exceptionally transparent reference.

The high frequency section consists of a 2.5" titanium diaphragm compression driver coupled to a 60-degree conical horn with accurate pattern control to avoid onstage bleed into nearby mixes. The combination assures unmatched transient response and even coverage across the entire control area.

The low frequency section uses 3.5" voice coil with dual forced air ventilation to provide high power handling and high excursion mid-bass.

Each powered cabinet houses a high-efficiency 1500 watt class D amplifier with built-in TI DSP and an optional Cobranet remote interface. Innovative post-filter feedback class-D topology achieves ruler-flat frequency response, low distortion and high damping across the whole audio band. Amplifiers use the latest generation power MOSFET transistors and highly optimized output stage for up to 95% efficiency, allowing for quiet fan-less operation achieving unprecedented power levels.

The cabinet is constructed from 100% void-free Baltic birch, CNC crafted to perfection and coated in the industries toughest ExL Polyurea finish. Not only is the finish 100% waterproof & chemical resistant, it outlasts any other manufactures coating by years. This coating is very easy to clean and maintain. A quick wipe down and 10 year old cabinets look like

they just rolled off the production line. Perforated metal black grills lined with acoustic black foam further enhances the weather resistant properties of double treated transducer cones.

CABINET DETAILS

DIMENSIONS	18.7"w x 13.4"h x 17.8"d (476mm x 340mm x 453mm)
WEIGHT POWERED	52 lbs (23.6kg)
ENCLOSURE	13ply 18mm void free Baltic birch
FINISH	ExL Polyurea - Standard Black available in any color
GRILL	Perforated metal grill lined with acoustical black foam
RIGGING	Perforated metal grill lined with acoustical black foam

TRANSDUCERS

LOW - 15" MID BASS NEODYMIUM	900w Continuous
HIGH - 2.5" DIAPHRAGM 1.4" EXIT	180w Continuous
NOMINAL IMPEDANCE	8ohm LF 8ohm H

ACOUSTICAL

OPERATING FREQUENCY	60hz - 20kHz
FREE FIELD RESPONSE	80hz - 18kHz +-3db
MAX SPL @ 1M	134db
HORIZONTAL COVERAGE	60°
VERTICAL COVERAGE	60°

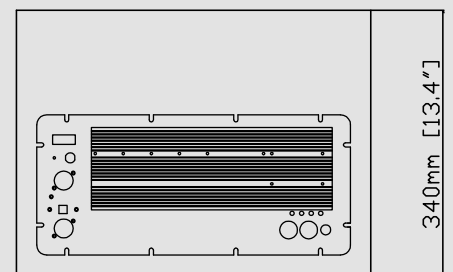
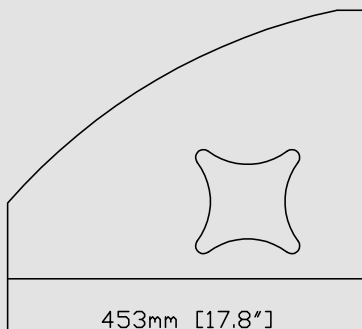



AMPLIFIER

TYPE	Class D - 300kHz Switching
EFFICIENCY	Up to 95%
POWER	1500 W
THD+N	>0.02%
DAMPING FACTOR	>200
INPUT	Balanced XLR
INPUT IMPEDANCE	50K ohm
OUTPUT	Balanced XLR
REMOTE CLIP MONITORING	Optional
COBRANET	Optional
DSP IN	HF 0db - 90hz HP
DSP OUT	HF -3db - 90hz HP

AC POWER

VOLTAGE	90-132VAC (190-255 Optional)
CONNECTOR	Neutrik Powercon
CONTINUOUS MAX CURRENT CONSUMPTION	6 amps (120VAC)